

## What is the issue?

Bigger & longer houses have hot water outlets that are further apart

### Standard solutions are inefficient, expensive & wasteful

#### Multiple water heaters

- High install cost
- Expensive to integrate renewable energy with multiple water heaters

#### Long pipe runs

- Long delays to use hot water
- Unnecessary water & energy use
- Complex plumbing design

## FlowSmart system

- ✓ smart controller prevents waste
- ✓ immediate hot water at outlet
- ✓ super low energy pump
- ✓ customisable control options

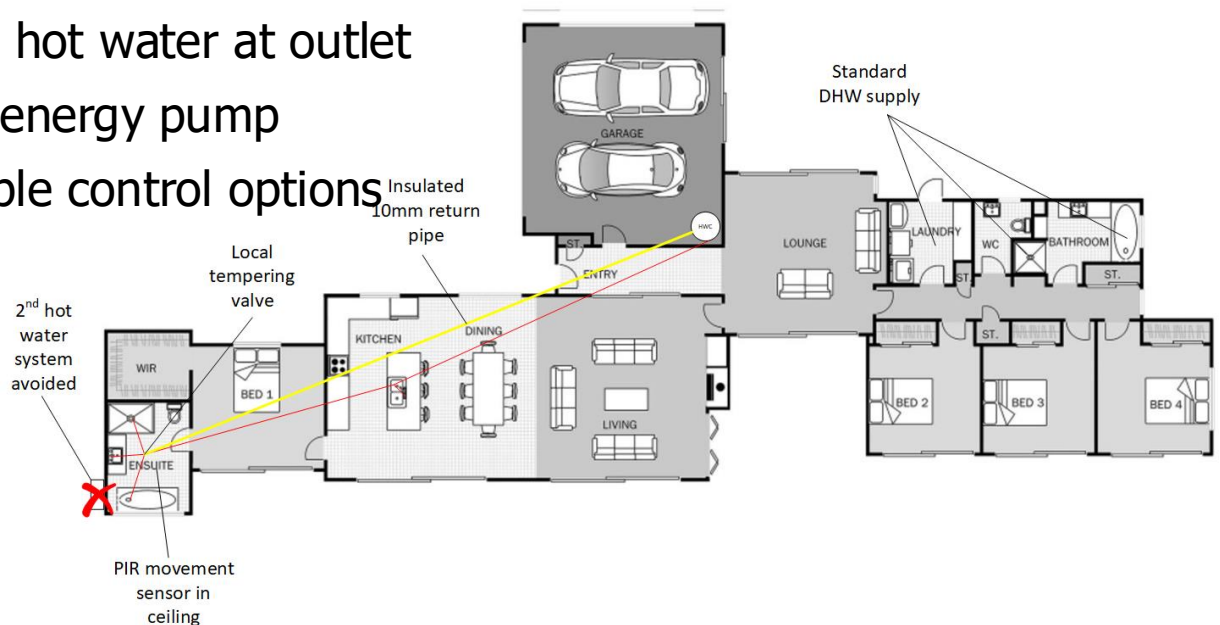

### FlowSmart includes:

- Intelligent thermostatic controller
- Grundfos ultra low energy pump (30 watts)
- Timer or PIR movement sensor activation

Great value compared to multiple water heaters

Extremely low running cost

Easily installation in new build & existing homes

**Savings · Sustainability · Independence**